

PLAN OF SUBDIVISION

EDITION

PS 734608P

<p>LOCATION OF LAND</p> <p>PARISH: MICKLEHAM</p> <p>TOWNSHIP: —</p> <p>SECTION: —</p> <p>CROWN ALLOTMENT: —</p> <p>CROWN PORTION: 24 (PART)</p> <p>TITLE REFERENCE: VOL FOL</p> <p>LAST PLAN REFERENCE: LOT L ON PS742714U</p> <p>POSTAL ADDRESS: DONNYBROOK ROAD (at time of subdivision) MICKLEHAM 3064</p> <p>MGA 94 CO-ORDINATES: E 314 725 N 5 843 775 Zone: 55 (approx. centre of land in plan)</p>	<p>Council Name: Hume City Council</p> <p>Council Reference Number: S007573 Planning Permit Reference: P16701 SPEAR Reference Number: S069451P</p> <p>Certification</p> <p>This plan is certified under section 6 of the Subdivision Act 1988</p> <p>Public Open Space</p> <p>A requirement for public open space under section 18 of the Subdivision Act 1988 Has been made and the requirement has not been satisfied at Certification</p> <p>Digitally signed by: Michelle Hutchings for Hume City Council on 29/02/2016</p>
--	---

VESTING OF ROADS AND/OR RESERVES

NOTATIONS

IDENTIFIER	COUNCIL/BODY/PERSON	STAGING
ROAD R1	HUME CITY COUNCIL	This is /is not a staged subdivision Planning Permit No. P16701
RESERVE No.1	HUME CITY COUNCIL	
RESERVE No.2	HUME CITY COUNCIL	
		DEPTH LIMITATION DOES NOT APPLY
		SURVEY This plan is/ is not based on survey This survey has been connected to permanent marks no(s) 21, 70 In Proclaimed Survey Area No. 74

OTHER PURPOSE OF PLAN

TO REMOVE THE WHOLE OF EASEMENTS E-4 AND E-13 AND THAT PART OF EASEMENT E-11 ON PS742714U NOW CONTAINED IN PRIMROSE CRESCENT ON THIS PLAN.

TO REMOVE THE WHOLE OF POWERLINE EASEMENT E-26 AND POWERLINE AND DRAINAGE EASEMENT E-29 ON PS742714U NOW CONTAINED IN NAPIER WAY ON THIS PLAN.

TO REMOVE THE WHOLE OF DRAINAGE EASEMENT E-30 ON PS742714U NOW CONTAINED IN NAPIER WAY AND PRIMROSE CRESCENT ON THIS PLAN.

GROUND'S FOR REMOVAL OF EASEMENTS

AGREEMENT BY ALL INTERESTED PARTIES.

EASEMENT INFORMATION

LEGEND: E – Encumbering Easement, Condition in Crown Grant in the Nature of an Easement or Other Encumbrance A – Appurtenant Easement

SUBJECT LAND	PURPOSE	WIDTH (METRES)	ORIGIN	LAND BENEFITED/IN FAVOUR OF
E-1 E-1	DRAINAGE SEWERAGE	SEE DIAG SEE DIAG	PS711404L PS711404L	HUME CITY COUNCIL YARRA VALLEY WATER CORPORATION
E-6 E-6 E-6	TRANSMISSION OF ELECTRICITY DRAINAGE SEWERAGE	SEE DIAG SEE DIAG SEE DIAG	C/E AL349952C PS711404L PS711404L	JEMENA ELECTRICITY NETWORKS (VIC) LTD HUME CITY COUNCIL YARRA VALLEY WATER CORPORATION
E-11	TRANSMISSION OF ELECTRICITY	SEE DIAG	C/E AL349952C	JEMENA ELECTRICITY NETWORKS (VIC) LTD
E-17 E-17	DRAINAGE SEWERAGE	SEE DIAG SEE DIAG	THIS PLAN THIS PLAN	HUME CITY COUNCIL YARRA VALLEY WATER CORPORATION

MERRIFIELD – 16

46 LOTS

LICENSED SURVEYOR GEOFFREY JAMES TURNER

DATE 29/09/15

REFERENCE 29005163

ORIGINAL SHEET SIZE A3

VERSION F

DRAWING 2900516AF

SHEET 1 OF 4 SHEETS

Bosco Jonson Pty Ltd

A.B.N 15 169 138 827
P.O. Box 5075, South Melbourne, Vic 3205
16 Eastern Road South Melbourne
Vic 3205 Australia
Tel 03) 9699 1400 Fax 03) 9699 5992



Digitally signed by: Geoffrey James Turner (Bosco Jonson Pty Ltd),
Surveyor's Plan Version (F),
08/10/2015

PLAN OF SUBDIVISION

PS 734608P

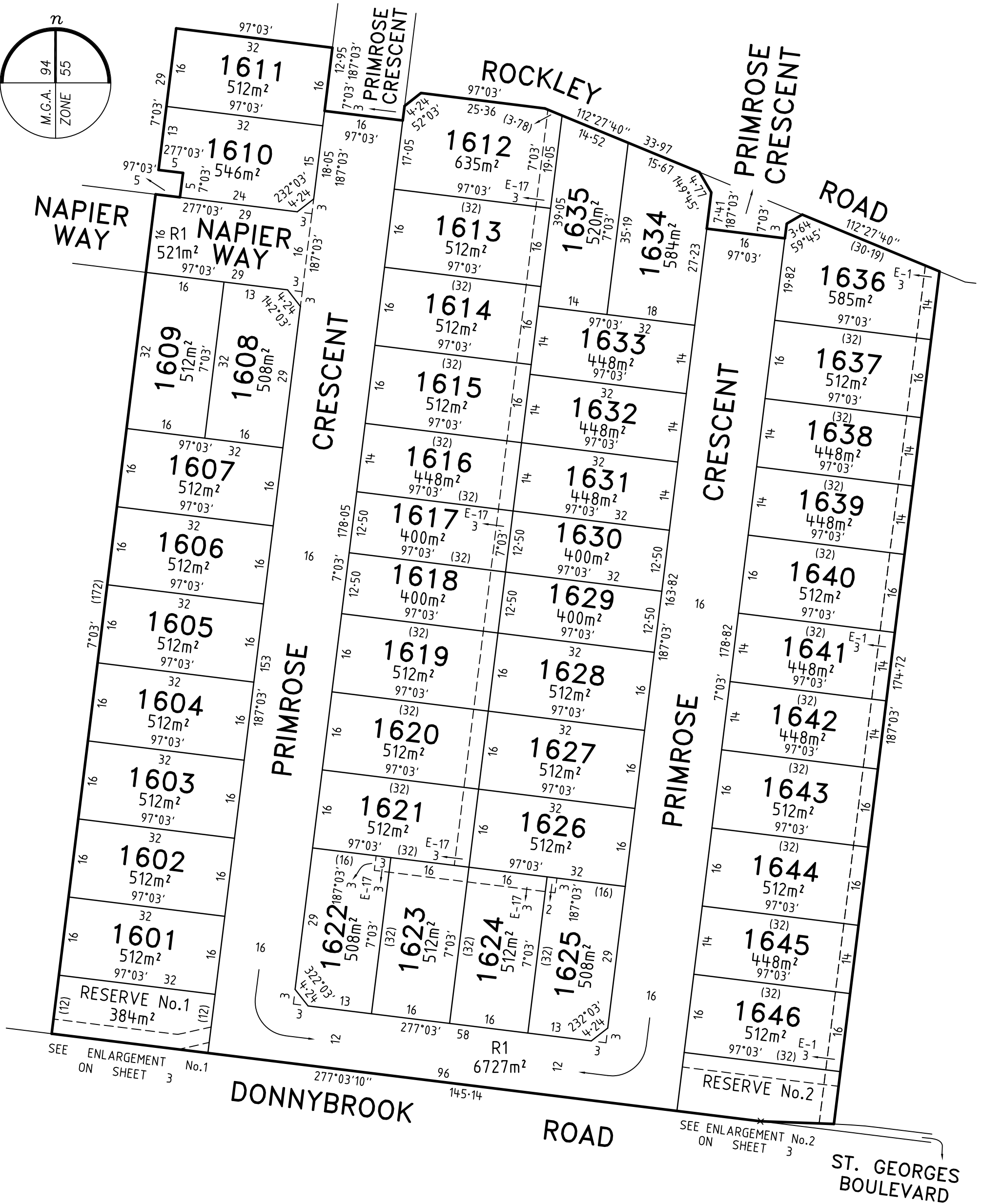
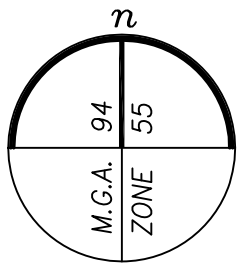

SEE ENLARGEMENT ON SHEET 3 No.1

SEE ENLARGEMENT No.2 ON SHEET 3

MERRIFIELD - 16 Bosco Jonson Pty Ltd A.B.N 15 169 138 827 P.O. Box 5075, South Melbourne, Vic 3205 16 Eastern Road South Melbourne Vic 3205 Australia Tel 03) 9699 1400 Fax 03) 9699 5992	LICENSED SURVEYOR GEOFFREY JAMES TURNER	SCALE 1:750	<p>LENGTHS ARE IN METRES</p>
	DATE 29/09/15 VERSION F	REFERENCE 29005163 DRAWING 2900516AF	ORIGINAL SHEET SIZE A3 SHEET 2
Digitally signed by: Geoffrey James Turner (Bosco Jonson Pty Ltd), Surveyor's Plan Version (F), 08/10/2015		Digitally signed by: Hume City Council, 29/02/2016, SPEAR Ref: S069451P	

PLAN OF SUBDIVISION

PS 734608P

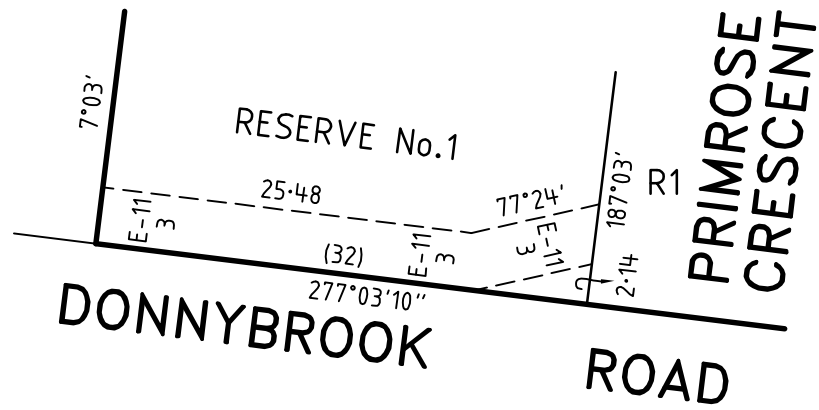
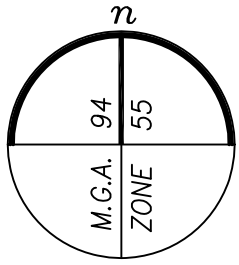

ENLARGEMENT No.1
NOT TO SCALE

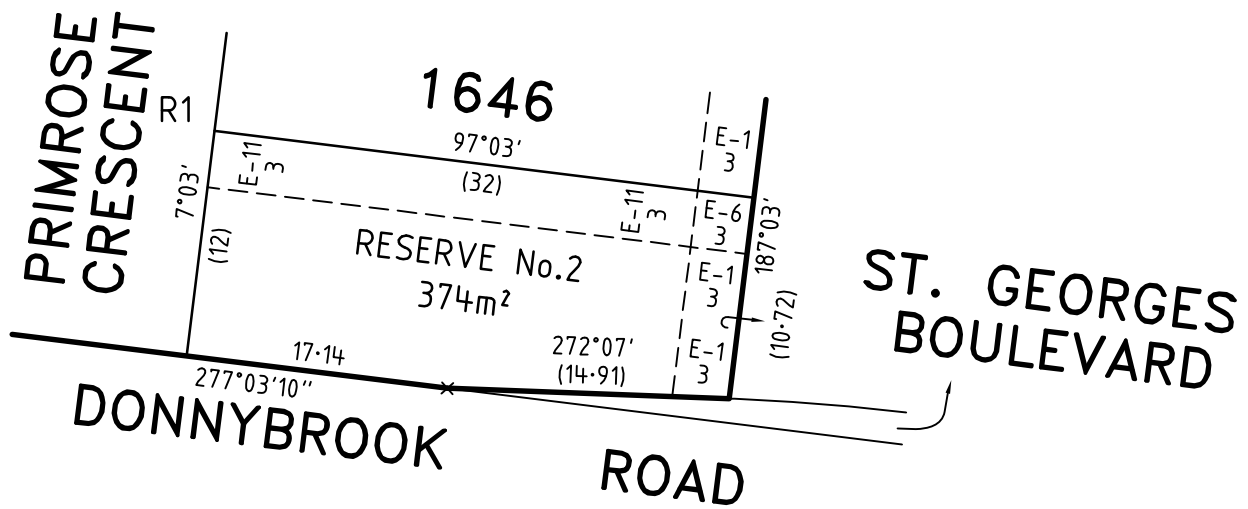

ENLARGEMENT No.2
NOT TO SCALE

MERRIFIELD - 16

Bosco Jonson Pty Ltd
A.B.N 15 169 138 827
P.O. Box 5075, South Melbourne, Vic 3205
16 Eastern Road South Melbourne
Vic 3205 Australia
Tel 03) 9699 1400 Fax 03) 9699 5992

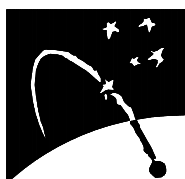

LICENSED SURVEYOR GEOFFREY JAMES TURNER

DATE 29/09/15
VERSION F

Digitally signed by: Geoffrey James Turner (Bosco Jonson Pty Ltd),
Surveyor's Plan Version (F),
08/10/2015

SCALE

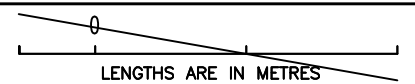

ORIGINAL SHEET SIZE A3

SHEET 3

Digitally signed by:
Hume City Council,
29/02/2016,
SPEAR Ref: S069451P

PLAN OF SUBDIVISION

PS 734608P

CREATION OF RESTRICTION A

UPON REGISTRATION OF THIS PLAN THE FOLLOWING RESTRICTION IS CREATED

DESCRIPTION OF RESTRICTION

TABLE OF LAND BURDENED AND LAND BENEFITED

BURDENED LOT No.	BENEFITING LOTS ON THIS PLAN
1601	1602
1602	1601, 1603
1603	1602, 1604
1604	1603, 1605
1605	1604, 1606
1606	1605, 1607
1607	1606, 1608, 1609
1608	1607, 1609
1609	1607, 1608
1610	1611
1611	1610
1612	1613, 1635
1613	1612, 1614, 1635
1614	1613, 1615, 1633, 1635
1615	1614, 1616, 1632, 1633
1616	1615, 1617, 1631
1617	1616, 1618, 1630
1618	1617, 1619, 1629
1619	1618, 1620, 1628
1620	1619, 1621, 1627
1621	1620, 1622, 1623, 1626
1622	1621, 1623
1623	1621, 1622, 1624

BURDENED LOT No.	BENEFITING LOTS ON THIS PLAN
1624	1623, 1625, 1626
1625	1624, 1626
1626	1621, 1624, 1625, 1627
1627	1620, 1626, 1628
1628	1619, 1627, 1629
1629	1618, 1628, 1630
1630	1617, 1629, 1631
1631	1616, 1630, 1632
1632	1615, 1631, 1633
1633	1614, 1615, 1632, 1634, 1635
1634	1633, 1635
1635	1612, 1613, 1614, 1633, 1634
1636	1637
1637	1636, 1638
1638	1637, 1639
1639	1638, 1640
1640	1639, 1641
1641	1640, 1642
1642	1641, 1643
1643	1642, 1644
1644	1643, 1645
1645	1644, 1646
1646	1645

THE REGISTERED PROPRIETOR OR PROPRIETORS FOR THE TIME BEING OF ANY BURDENED LOT ON THIS PLAN MUST NOT

1. BUILD OR PERMIT TO BE BUILT OR REMAIN ON THE LOT ANY BUILDING OR STRUCTURE OTHER THAN A BUILDING THAT HAS BEEN CONSTRUCTED IN ACCORDANCE WITH PLANS, DRAWINGS, DESIGNS AND SPECIFICATIONS THAT HAVE FIRST BEEN APPROVED BY THE MERRIFIELD LIVING DESIGN REVIEW COMMITTEE IN ACCORDANCE WITH THE "MERRIFIELD LIVING DESIGN GUIDELINES" AS AMENDED FROM TIME TO TIME.
2. SUBDIVIDE OR CAUSE TO SUBDIVIDE OR ALLOW TO BE SUBDIVIDED THE BURDENED LAND.
3. BUILD OR PERMIT TO BE BUILT OR REMAIN ON THE LOT MORE THAN ONE DWELLING.

MERRIFIELD – 16

Bosco Jonson Pty Ltd
 A.B.N 15 169 138 827
 P.O. Box 5075, South Melbourne, Vic 3205
 16 Eastern Road South Melbourne
 Vic 3205 Australia
 Tel 03) 9699 1400 Fax 03) 9699 5992

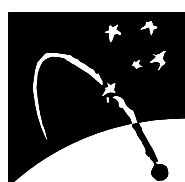

LICENSED SURVEYOR GEOFFREY JAMES TURNER

SCALE

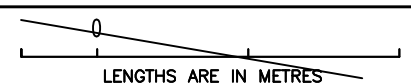

DATE 29/09/15
 VERSION F

REFERENCE 29005163
 DRAWING 2900516AF

ORIGINAL SHEET SIZE A3

SHEET 4

Digitally signed by: Geoffrey James Turner (Bosco Jonson Pty Ltd),
 Surveyor's Plan Version (F),
 08/10/2015

Digitally signed by:
 Hume City Council,
 29/02/2016,
 SPEAR Ref: S069451P