



PLAN OF SUBDIVISION				EDITION 2	PS 746036S
<div style="display: flex; justify-content: space-between;"> <div> <p>LOCATION OF LAND</p> <p>PARISH: MICKLEHAM</p> <p>TOWNSHIP: —</p> <p>SECTION: —</p> <p>CROWN ALLOTMENT: —</p> <p>CROWN PORTION: 24 (PART)</p> <p>TITLE REFERENCE: VOL 11828 FOL 730</p> <p>LAST PLAN REFERENCE: LOT A ON PS742801A</p> <p>POSTAL ADDRESS: DONNYBROOK ROAD (at time of subdivision) MICKLEHAM 3064</p> <p>MGA 94 CO-ORDINATES: E 314 400 (approx. centre of land in plan) N 5 843 950 Zone: 55</p> </div> <div> <p>Council Name: Hume City Council</p> <p>Council Reference Number: S007823 Planning Permit Reference: P19036 SPEAR Reference Number: S082576V</p> <p>Certification</p> <p>This plan is certified under section 11 (7) of the Subdivision Act 1988 Date of original certification under section 6: 03/08/2016</p> <p>Statement of Compliance</p> <p>This is a statement of compliance issued under section 21 of the Subdivision Act 1988</p> <p>Growth Areas Infrastructure Contribution</p> <p>Yes, the land associated with this Statement of Compliance is subject to GAIC.</p> <p>Public Open Space</p> <p>A requirement for public open space under section 18 of the Subdivision Act 1988 has been made and the requirement has been satisfied for: this stage</p> <p>Digitally signed by: Michelle Hutchings for Hume City Council on 09/08/2017</p> </div> </div>				<p style="text-align: center; font-weight: bold;">NOTATIONS</p> <p>STAGING This is is not a staged subdivision Planning Permit No. P19036</p> <p>DEPTH LIMITATION DOES NOT APPLY</p> <p>SURVEY This plan is is not based on survey This survey has been connected to permanent marks no(s) 21, 70 In Proclaimed Survey Area No. 74</p> <p>LAND SUBDIVIDED - 8.153ha</p> <p>LOTS 1 TO 2100 (BOTH INCLUSIVE), 2177, 2192, A & B HAVE BEEN OMITTED FROM THIS PLAN.</p> <p>EASEMENTS E-2 TO E-17 (BOTH INCLUSIVE) HAVE BEEN OMITTED FROM THIS PLAN.</p> <p>TANGENT POINTS ARE SHOWN THUS: </p> <p>THE WHOLE OF THE LAND IN THIS PLAN HAS AN APPURTENANT CARRIAGEWAY EASEMENT CREATED IN PS746062R.</p>	
VESTING OF ROADS AND/OR RESERVES				NOTATIONS	
IDENTIFIER		COUNCIL/BODY/PERSON		<p>STAGING This is is not a staged subdivision Planning Permit No. P19036</p> <p>DEPTH LIMITATION DOES NOT APPLY</p> <p>SURVEY This plan is is not based on survey This survey has been connected to permanent marks no(s) 21, 70 In Proclaimed Survey Area No. 74</p> <p>LAND SUBDIVIDED - 8.153ha</p> <p>LOTS 1 TO 2100 (BOTH INCLUSIVE), 2177, 2192, A & B HAVE BEEN OMITTED FROM THIS PLAN.</p> <p>EASEMENTS E-2 TO E-17 (BOTH INCLUSIVE) HAVE BEEN OMITTED FROM THIS PLAN.</p> <p>TANGENT POINTS ARE SHOWN THUS: </p> <p>THE WHOLE OF THE LAND IN THIS PLAN HAS AN APPURTENANT CARRIAGEWAY EASEMENT CREATED IN PS746062R.</p>	
<p>ROAD R1 RESERVE No.1 RESERVE No.2</p>		<p>HUME CITY COUNCIL HUME CITY COUNCIL HUME CITY COUNCIL</p>		<p>OTHER PURPOSE OF PLAN</p> <p>TO REMOVE THE WHOLE OF EASEMENT E-11 ON PS742801A (NOW CONTAINED IN CANNING DRIVE ON THIS PLAN).</p> <p>TO REMOVE THAT PART OF EASEMENT E-19 ON PS742801A NOW CONTAINED IN MATHOURA ROAD ON THIS PLAN.</p> <p>TO REMOVE THE WHOLE OF EASEMENT E-21 ON PS742801A.</p> <p>TO REMOVE THAT PART OF EASEMENT E-19 ON PS742801A NOW CONTAINED IN ROWENA WAY ON THIS PLAN.</p> <p>TO REMOVE THE WHOLE OF EASEMENTS E-27 AND E-28 ON PS742801A (NOW CONTAINED IN BENDIGO STREET ON THIS PLAN).</p> <p>GROUND FOR REMOVAL OF EASEMENTS AGREEMENT BY ALL INTERESTED PARTIES.</p>	
EASEMENT INFORMATION					
<p>LEGEND: E — Encumbering Easement, Condition in Crown Grant in the Nature of an Easement or Other Encumbrance A — Appurtenant Easement</p>					
SUBJECT LAND	PURPOSE	WIDTH (METRES)	ORIGIN	LAND BENEFITED/IN FAVOUR OF	
E-1 E-1	DRAINAGE SEWERAGE	SEE DIAG SEE DIAG	THIS PLAN THIS PLAN	HUME CITY COUNCIL YARRA VALLEY WATER CORPORATION	
E-18 E-18	DRAINAGE SEWERAGE	SEE DIAG SEE DIAG	PS742712Y PS742712Y	HUME CITY COUNCIL YARRA VALLEY WATER CORPORATION	
E-19 E-19	DRAINAGE SEWERAGE	SEE DIAG SEE DIAG	PS742713W PS742713W	HUME CITY COUNCIL YARRA VALLEY WATER CORPORATION	
MERRIFIELD — 21			LICENSED SURVEYOR GEOFFREY JAMES TURNER		
95 LOTS AND BALANCE LOTS C & D			<div style="display: flex; justify-content: space-between;"> <div> <p>Bosco Jonson Pty Ltd A.B.N 15 169 138 827 P.O. Box 5075, South Melbourne, Vic 3205 16 Eastern Road South Melbourne Vic 3205 Australia Tel 03) 9699 1400 Fax 03) 9699 5992</p> </div> <div>  </div> </div>		
<p>DATE 07/06/17 REFERENCE 29005213</p> <p>VERSION L DRAWING 2900521AL</p> <p>Digitally signed by: Geoffrey James Turner (Bosco Jonson Pty Ltd), Surveyor's Plan Version (L), 08/06/2017, SPEAR Ref: S082576V</p>			<p>ORIGINAL SHEET SIZE A3</p> <p>SHEET 1 OF 8 SHEETS</p> <p>PLAN REGISTERED TIME: 02:46 pm DATE: 17/08/2017 Assistant Registrar of Titles</p>		

PS 746036S



PS746036S, Page 2 of 9, 15:43 22/01/2018, Customer hl03

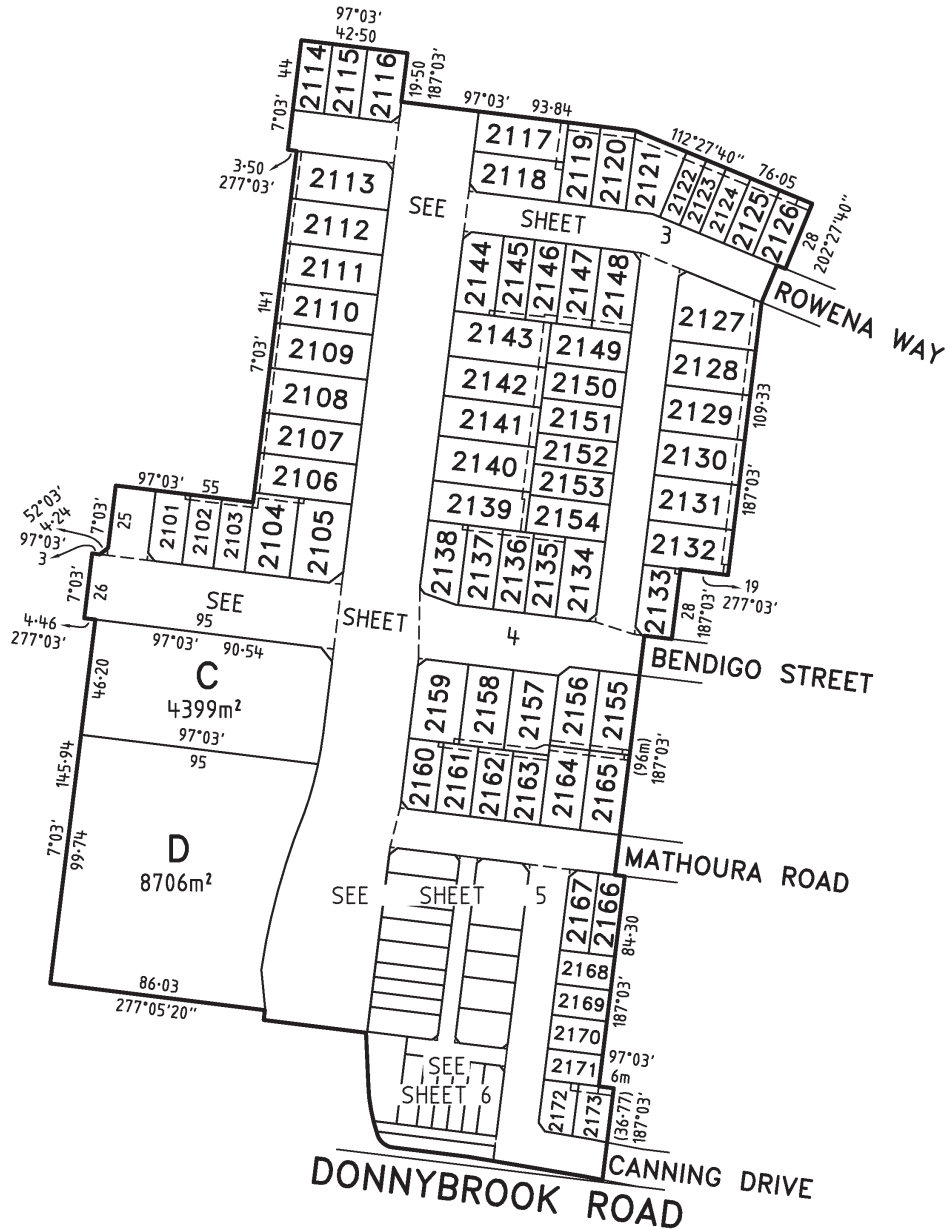
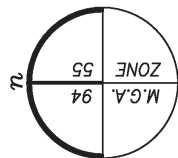

PLAN OF SUBDIVISION

PS 746036S

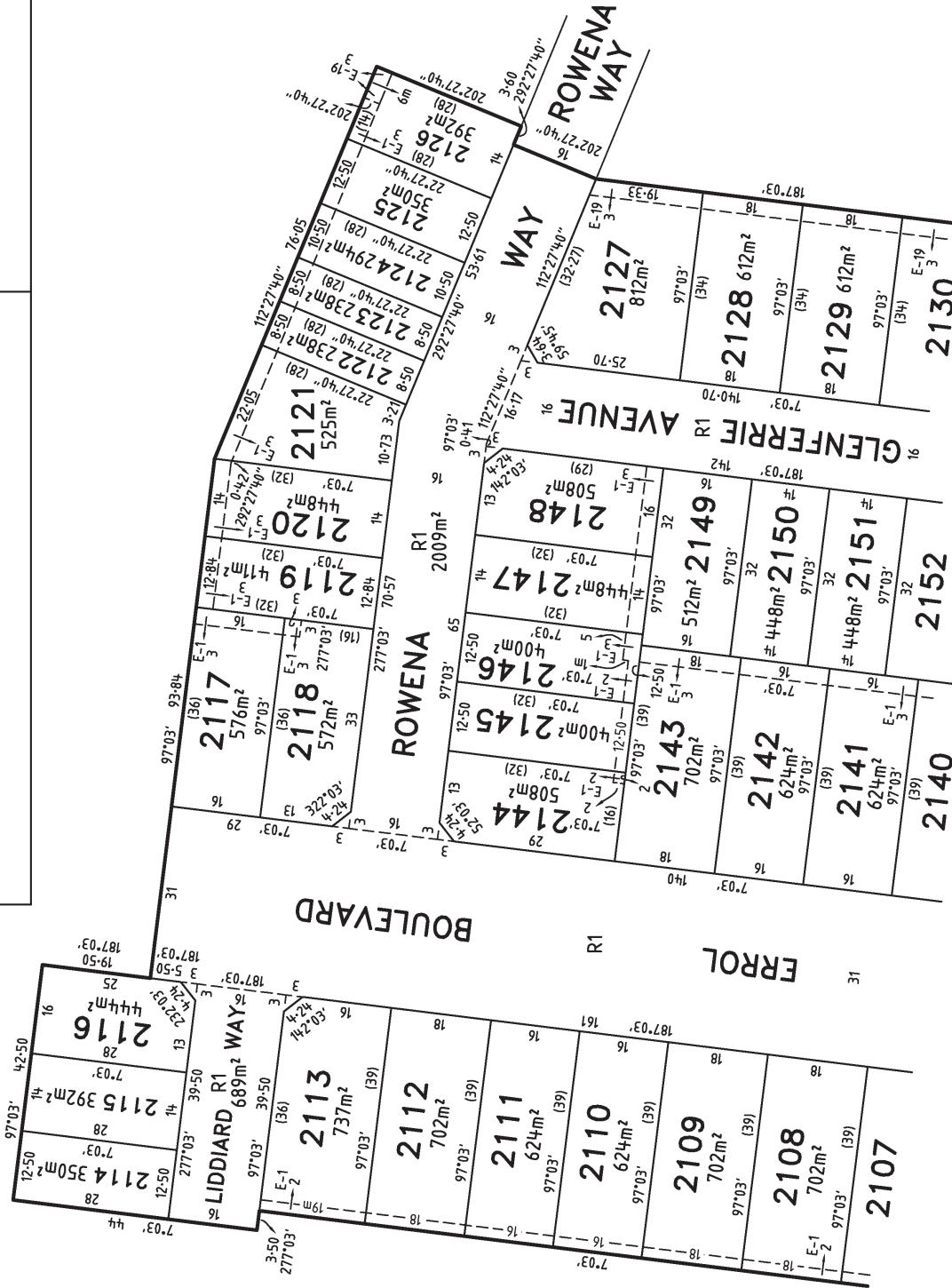

SEE SHEET 4



Bosco Jonson Pty Ltd
A.B.N 15 169 138 827
P.O. Box 5075, South Melbourne, Vic 3205
16 Eastern Road South Melbourne
Vic 3205 Australia
Tel 03 9699 1400 Fax 03 9699 5992

MERRIFIELD - 21
LICENSED SURVEYOR GEOFFREY JAMES TURNER

DATE 07/06/17
VERSION L
REFERENCE 29005213
DRAWING 2900521AL

LENGTHS ARE IN METRES
8 0 16 32

SCALE
1:800

ORIGINAL SHEET SIZE A3
SHEET 3

Digitally signed by: Geoffrey James Turner (Bosco Jonson Pty Ltd),
Surveyor's Plan Version (L),
09/06/2017, SPEAR Ref: S082576V

Digitally signed by: Hume City Council,
09/08/2017,
SPEAR Ref: S082576V

Amended by: Geoffrey James Turner, 17/08/2017.

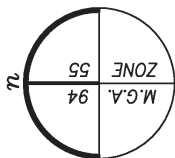

PLAN OF SUBDIVISION

PS 746036S

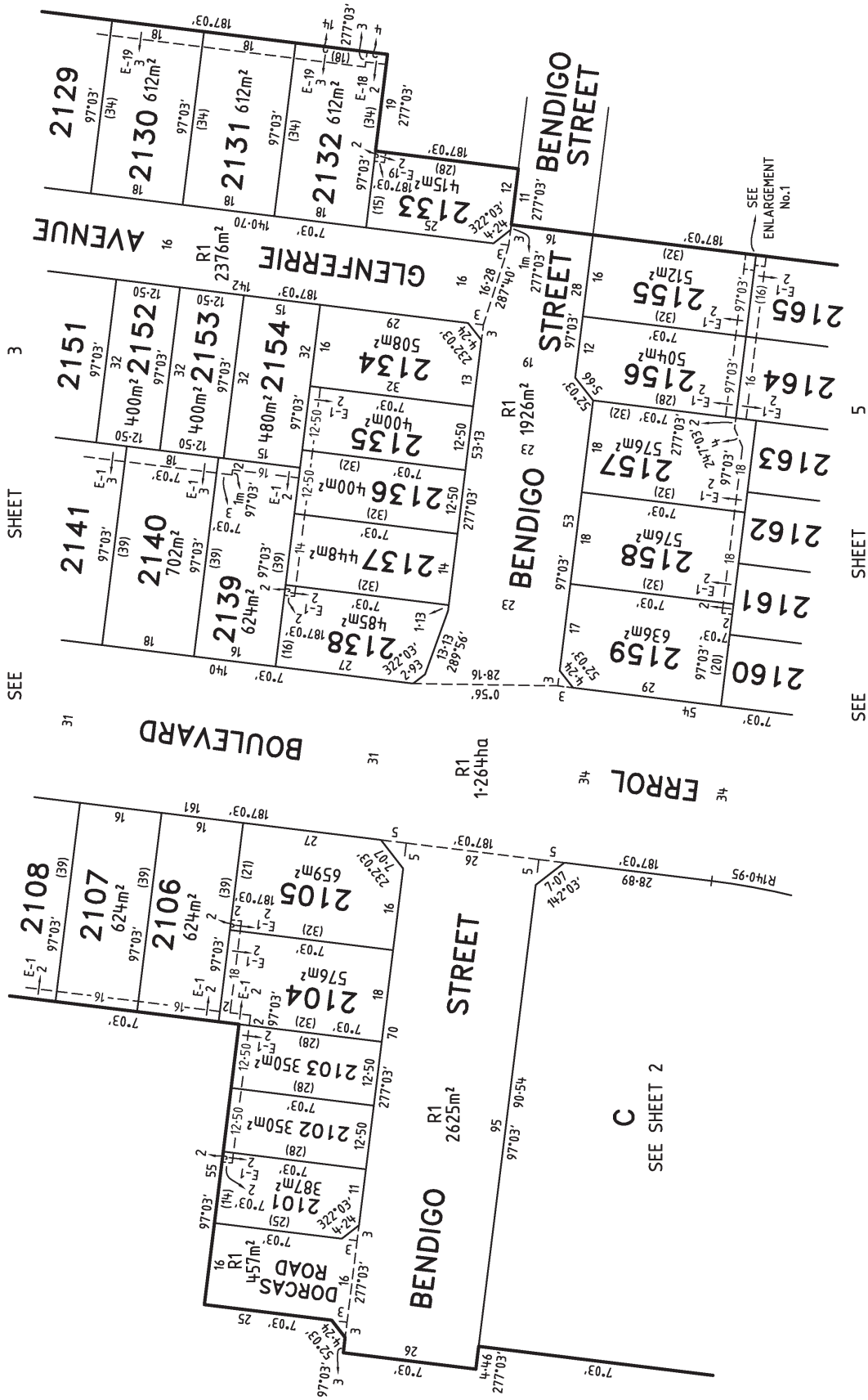

ENLARGEMENT No.1
NOT TO SCALE



Bosco Jonson Pty Ltd
A.B.N 15 169 138 827
P.O. Box 5075, South Melbourne, Vic 3205
16 Eastern Road South Melbourne
Vic 3205 Australia
Tel 03) 9699 1400 Fax 03) 9699 5992

MERRIFIELD - 21
LICENSED SURVEYOR GEOFFREY JAMES TURNER

DATE 07/06/17
VERSION L
REFERENCE 29005213
DRAWING 2900521AL

Digitally signed by: Geofffrey James Turner (Bosco Jonson Pty Ltd),
09/08/2017, SPEAR Ref: S082576V

Digitally signed by: Hume City Council,
09/08/2017, SPEAR Ref: S082576V

SCALE
1:800

ORIGINAL SHEET SIZE A3
SHEET 4

Amended by: Geofffrey James Turner, 17/08/2017.

PLAN OF SUBDIVISION

PS 746036S

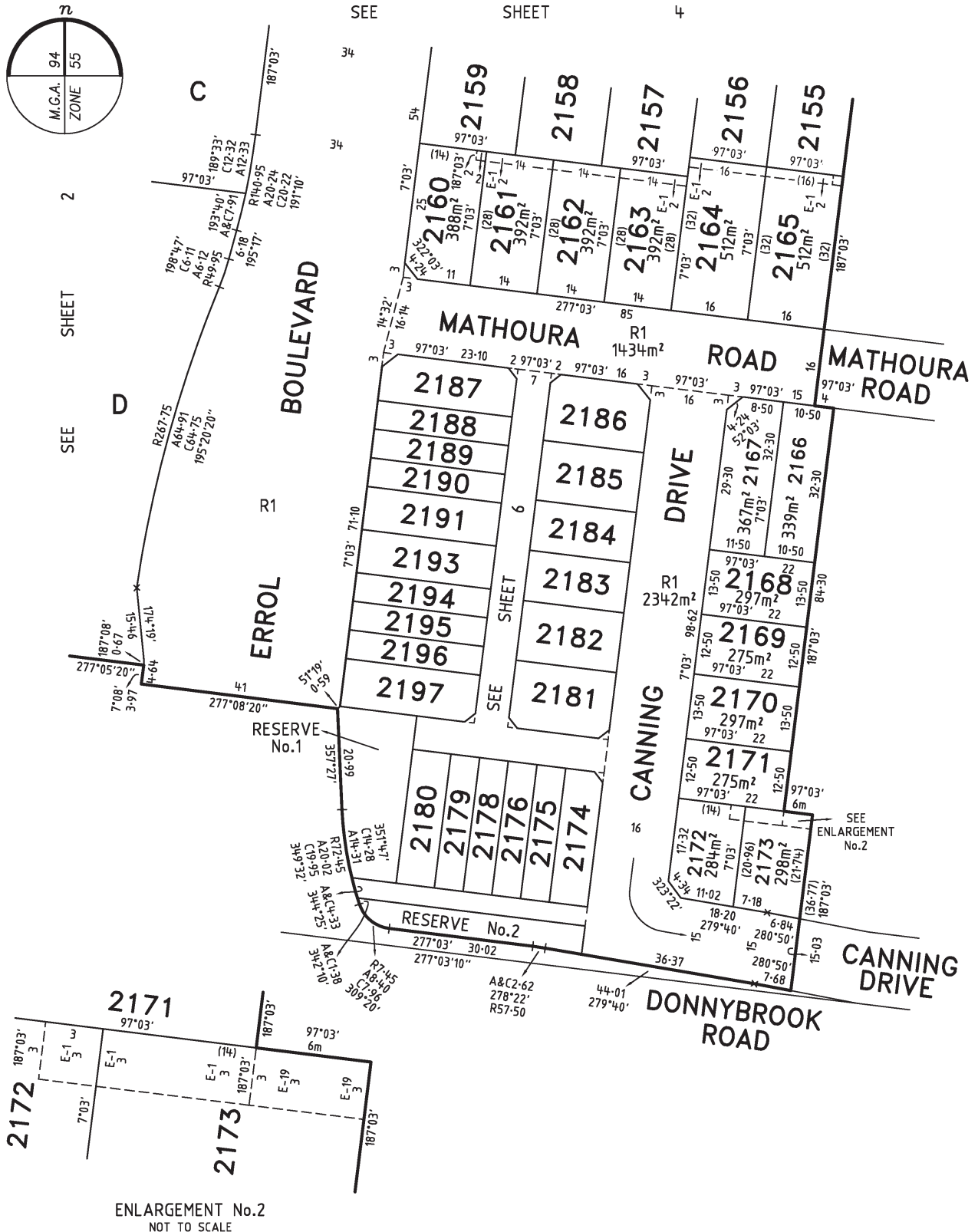
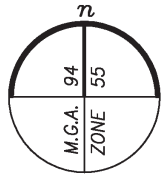

ENLARGEMENT No.2
NOT TO SCALE

MERRIFIELD - 21

Bosco Jonson Pty Ltd
A.B.N 15 169 138 827
P.O. Box 5075, South Melbourne, Vic 3205
16 Eastern Road South Melbourne
Vic 3205 Australia
Tel 03) 9699 1400 Fax 03) 9699 5992



LICENSED SURVEYOR GEOFFREY JAMES TURNER

SCALE
1:800

8 0 16 32
LENGTHS ARE IN METRES

DATE 07/06/17
VERSION L

REFERENCE 29005213
DRAWING 2900521A

ORIGINAL SHEET SIZE A3

SHEET 5

Digitally signed by: Geoffrey James Turner (Bosco Jonson Pty Ltd),
Surveyor's Plan Version (L),
08/06/2017, SPEAR Ref: S082576V

Digitally signed by:
Hume City Council,
09/08/2017,
SPEAR Ref: S082576V

PLAN OF SUBDIVISION

PS 746036S

SEE SHEET 5

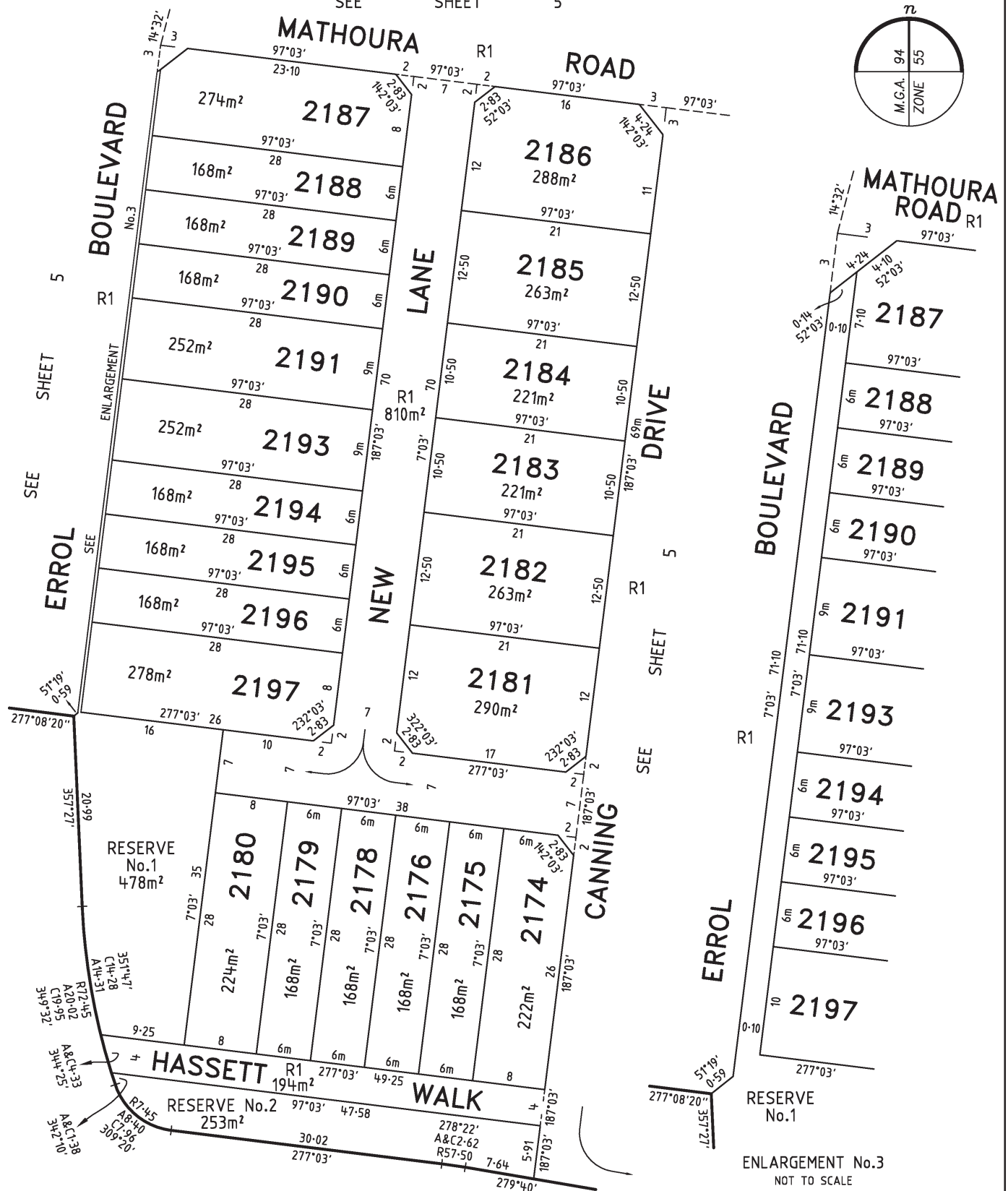
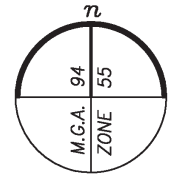

MERRIFIELD - 21

LICENSED SURVEYOR GEOFFREY JAMES TURNER

SCALE
1:400

4 0 8 16
LENGTHS ARE IN METRES

Bosco Jonson Pty Ltd
A.B.N 15 169 138 827
P.O. Box 5075, South Melbourne, Vic 3205
16 Eastern Road South Melbourne
Vic 3205 Australia
Tel 03) 9699 1400 Fax 03) 9699 5992



DATE 07/06/17
VERSION L

REFERENCE 29005213
DRAWING 2900521AL

ORIGINAL SHEET SIZE A3
SHEET 6

Digitally signed by: Geoffrey James Turner (Bosco Jonson Pty Ltd),
Surveyor's Plan Version (L),
08/06/2017, SPEAR Ref: S082576V

Digitally signed by:
Hume City Council,
09/08/2017,
SPEAR Ref: S082576V

PLAN OF SUBDIVISION		PS 746036S	
CREATION OF RESTRICTION A UPON REGISTRATION OF THIS PLAN THE FOLLOWING RESTRICTION IS CREATED			
DESCRIPTION OF RESTRICTION TABLE OF LAND BURDENED AND LAND BENEFITED			
BURDENED LOT No.		BURDENED LOT No.	
2101		2102	
2102		2101, 2103	
2103		2102, 2104	
2104		2103, 2105, 2106	
2105		2104, 2106	
2106		2104, 2105, 2107	
2107		2106, 2108	
2108		2107, 2109	
2109		2108, 2110	
2110		2109, 2111	
2111		2110, 2112	
2112		2111, 2113	
2113		2112	
2114		2115	
2115		2114, 2116	
2116		2115	
BURDENED LOT No.		BURDENED LOT No.	
2152		2140, 2141, 2151, 2153	
2153		2139, 2140, 2152, 2154	
2154		2134, 2135, 2136, 2139, 2153	
2155		2156, 2165	
2156		2155, 2157, 2164	
2157		2156, 2158, 2162, 2163, 2164	
2158		2157, 2159, 2161, 2162	
2159		2158, 2160, 2161	
2160		2159, 2161	
2161		2158, 2159, 2160, 2162	
2162		2157, 2158, 2161, 2163	
2163		2157, 2162, 2164	
2164		2156, 2157, 2163, 2165	
2165		2155, 2164	
2166		2167, 2168	
2167		2166, 2168	
BURDENED LOT No.		BURDENED LOT No.	
2136		2135, 2137, 2139, 2154	
2137		2136, 2138, 2139	
2138		2137, 2139	
2139		2136, 2137, 2138, 2140, 2153, 2154	
2140		2139, 2141, 2152, 2153	
2141		2140, 2142, 2151, 2152	
2142		2141, 2143, 2150, 2151	
2143		2142, 2144, 2145, 2146, 2149, 2150	
2144		2143, 2145	
2145		2143, 2144, 2146	
2146		2143, 2145, 2147, 2149	
2147		2146, 2148, 2149	
2148		2147, 2149	
2149		2143, 2146, 2147, 2148, 2150	
2150		2142, 2143, 2149, 2151	
2151		2141, 2142, 2150, 2152	
BURDENED LOT No.		BURDENED LOT No.	
2117		2118, 2119	
2118		2117, 2119	
2119		2117, 2118, 2120	
2120		2119, 2121	
2121		2120, 2122	
2125		2124, 2126	
2126		2125	
2127		2128	
2128		2127, 2129	
2129		2128, 2130	
2130		2129, 2131	
2131		2130, 2132	
2132		2131, 2133	
2133		2132	
2134		2135, 2154	
2135		2134, 2136, 2154	
THE REGISTERED PROPRIETOR OR PROPRIETORS FOR THE TIME BEING OF ANY BURDENED LOT ON THIS PLAN MUST NOT			
1. BUILD OR PERMIT TO BE BUILT OR REMAIN ON THE LOT ANY BUILDING OR STRUCTURE OTHER THAN A BUILDING THAT HAS BEEN CONSTRUCTED IN ACCORDANCE WITH PLANS, DRAWINGS, DESIGNS AND SPECIFICATIONS THAT HAVE FIRST BEEN APPROVED BY THE MERRIFIELD LIVING DESIGN REVIEW COMMITTEE IN ACCORDANCE WITH THE "MERRIFIELD LIVING DESIGN GUIDELINES" AS AMENDED FROM TIME TO TIME.			
2. SUBDIVIDE OR CAUSE TO SUBDIVIDE OR ALLOW TO BE SUBDIVIDED THE BURDENED LAND.			
3. BUILD OR PERMIT TO BE BUILT OR REMAIN ON THE LOT MORE THAN ONE DWELLING.			
MERRIFIELD – 21		SCALE	
LICENSED SURVEYOR GEOFFREY JAMES TURNER		ORIGINAL SHEET SIZE A3	
DATE 07/06/17 REFERENCE 29005213		SHEET 7	
VERSION L DRAWING 2900521AL		Digitally signed by: Geoffrey James Turner (Bosco Jonson Pty Ltd), Surveyor's Plan Version (L), 08/06/2017, SPEAR Ref: S082576V	
Bosco Jonson Pty Ltd A.B.N 16 169 138 827 P.O. Box 5075, South Melbourne, Vic 3205 16 Eastern Road South Melbourne Vic 3205 Australia Tel 03) 9699 1400 Fax 03) 9699 5992		Digitally signed by: Geoffrey James Turner (Bosco Jonson Pty Ltd), Surveyor's Plan Version (L), 08/06/2017, SPEAR Ref: S082576V	

PLAN OF SUBDIVISION

PS 746036S

CREATION OF RESTRICTION B

UPON REGISTRATION OF THIS PLAN THE FOLLOWING RESTRICTION IS CREATED

DESCRIPTION OF RESTRICTION

TABLE OF LAND BURDENED AND LAND BENEFITED

BURDENED LOTS SUBJECT TO THE SMALL LOT HOUSING CODE	BENEFITING LOTS ON THIS PLAN
2122	2121, 2123
2123	2122, 2124
2124	2123, 2125
2168	2166, 2167, 2169
2169	2168, 2170
2170	2169, 2171
2171	2170, 2172, 2173
2172	2171, 2173
2173	2171, 2172
2174	2175
2175	2174, 2176
2176	2175, 2178
2178	2176, 2179
2179	2178, 2180
2180	2179
2181	2182

BURDENED LOTS SUBJECT TO THE SMALL LOT HOUSING CODE	BENEFITING LOTS ON THIS PLAN
2182	2181, 2183
2183	2182, 2184
2184	2183, 2185
2185	2184, 2186
2186	2185
2187	2188
2188	2187, 2189
2189	2188, 2190
2190	2189, 2191
2191	2190, 2193
2193	2191, 2194
2194	2193, 2195
2195	2194, 2196
2196	2195, 2197
2197	2196

THE REGISTERED PROPRIETOR OR PROPRIETORS FOR THE TIME BEING OF ANY BURDENED LOT ON THIS PLAN IN THE TABLE AS A LOT SUBJECT TO THE 'SMALL LOT HOUSING CODE (TYPE A)' MUST NOT BUILD OR PERMIT TO BE BUILT OR REMAIN ON THE LOT ANY BUILDING OR STRUCTURE THAT HAS NOT BEEN CONSTRUCTED IN ACCORDANCE WITH THE 'SMALL LOT HOUSING CODE (TYPE A)' UNLESS IN ACCORDANCE WITH A PERMIT GRANTED TO CONSTRUCT A DWELLING ON THE LOT. THIS RESTRICTION SHALL CEASE TO HAVE EFFECT AFTER THE ISSUE OF CERTIFICATE OF OCCUPANCY FOR THE WHOLE OF THE DWELLING ON THE LOT.

CREATION OF RESTRICTION D

UPON REGISTRATION OF THIS PLAN THE FOLLOWING RESTRICTION IS CREATED

LAND TO BENEFIT: LOTS 2172, 2173, 2174 TO 2176, 2178 TO 2180, 2187 TO 2191 & 2193 TO 2197 (ALL INCLUSIVE) ON THIS PLAN.

LAND TO BE BURDENED: LOTS 2172, 2173, 2174 TO 2176, 2178 TO 2180, 2187 TO 2191 & 2193 TO 2197 (ALL INCLUSIVE) ON THIS PLAN.

DESCRIPTION OF RESTRICTION

THE REGISTERED PROPRIETOR OR PROPRIETORS FOR THE TIME BEING OF ANY BURDENED LOT ON THIS PLAN MUST NOT BUILD OR PERMIT TO BE BUILT OR REMAIN ON THE LOT A SINGLE STOREY DWELLING

MERRIFIELD — 21

Bosco Jonson Pty Ltd
A.B.N 15 169 138 827
P.O. Box 5075, South Melbourne, Vic 3205
16 Eastern Road South Melbourne
Vic 3205 Australia
Tel 03) 9699 1400 Fax 03) 9699 5992



LICENSED SURVEYOR GEOFFREY JAMES TURNER

DATE 07/06/17
VERSION L

REFERENCE 29005213
DRAWING 2900521AL

Digitally signed by: Geoffrey James Turner (Bosco Jonson Pty Ltd),
Surveyor's Plan Version (L),
08/06/2017, SPEAR Ref: S082576V

SCALE



LENGTHS ARE IN METRES

ORIGINAL SHEET SIZE A3

SHEET 8

Digitally signed by:
Hume City Council,
09/08/2017,
SPEAR Ref: S082576V

RECORD OF ALL ADDITIONS OR CHANGES TO THE PLAN

PS746036S

WARNING: THE IMAGE OF THIS DOCUMENT OF THE REGISTER HAS BEEN DIGITALLY AMENDED.
NO FURTHER AMENDMENTS ARE TO BE MADE TO THE ORIGINAL DOCUMENT OF THE REGISTER.

[illegible]