

CAD FILE: F:\SYNERGY\TEMP\1205\ENERGY\SERVER\1205\ENERGY\17040-53-RD201-0202.DWG
PLOT DATE: 20/11/2023

T.B.M. NO.	EASTING (m)	NORTHING (m)	A.H.D LEVEL (m)	DESCRIPTION	TBM DATE OF SURVEY
100	315123.17	584524.169	235.23	STAR PICKET	3/12/2021
101	315125.32	5845363.70	234.04	STAR PICKET	3/12/2021
107	315260.93	5845477.30	232.545	STAR PICKET	3/12/2021

NOTE: TBM AT EXISTING SURFACE

REV	DESCRIPTION	APPROVED	DATE
2	AS CONSTRUCTED	J.J.	20.10.23
1	DRAINAGE STUB TO FUTURE LANEWAY ADDED	G.R.	15.12.22
0	CONSTRUCTION ISSUE	G.R.	29.11.22

DRAWN: M.HURA
DESIGNED: A.ARABO
VERIFIED: P.MASEMANN
APPROVED: G.ROMANCZ

H 1 : 500
@ A1



CLIENT:

merrifield
MAB gpc

verve
Ground Floor, 207-213 Waverley Road,
Malvern East VIC 3145
TEL : 03 8573 1500 verveprojects.com
© Verve Projects Pty Ltd.

COUNCIL:

HUME CITY COUNCIL

MERRIFIELD LIVING - SECTION E
STAGE 53
MICKLEHAM

TITLE:

DETAIL PLAN
SHEET 2

ISSUE: **AS CONSTRUCTED**

MELWAY REF:
366 F1

PROJECT No:
17040-53

DWG No:
RD202

REVISION:
2

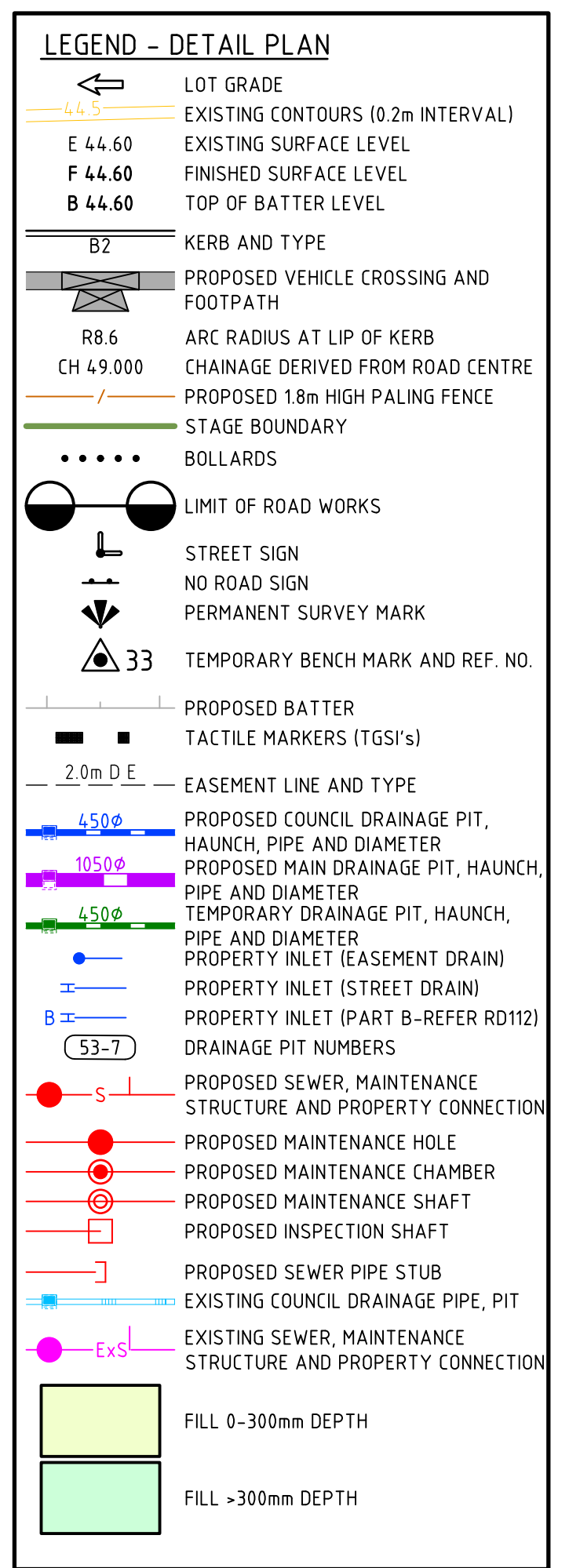
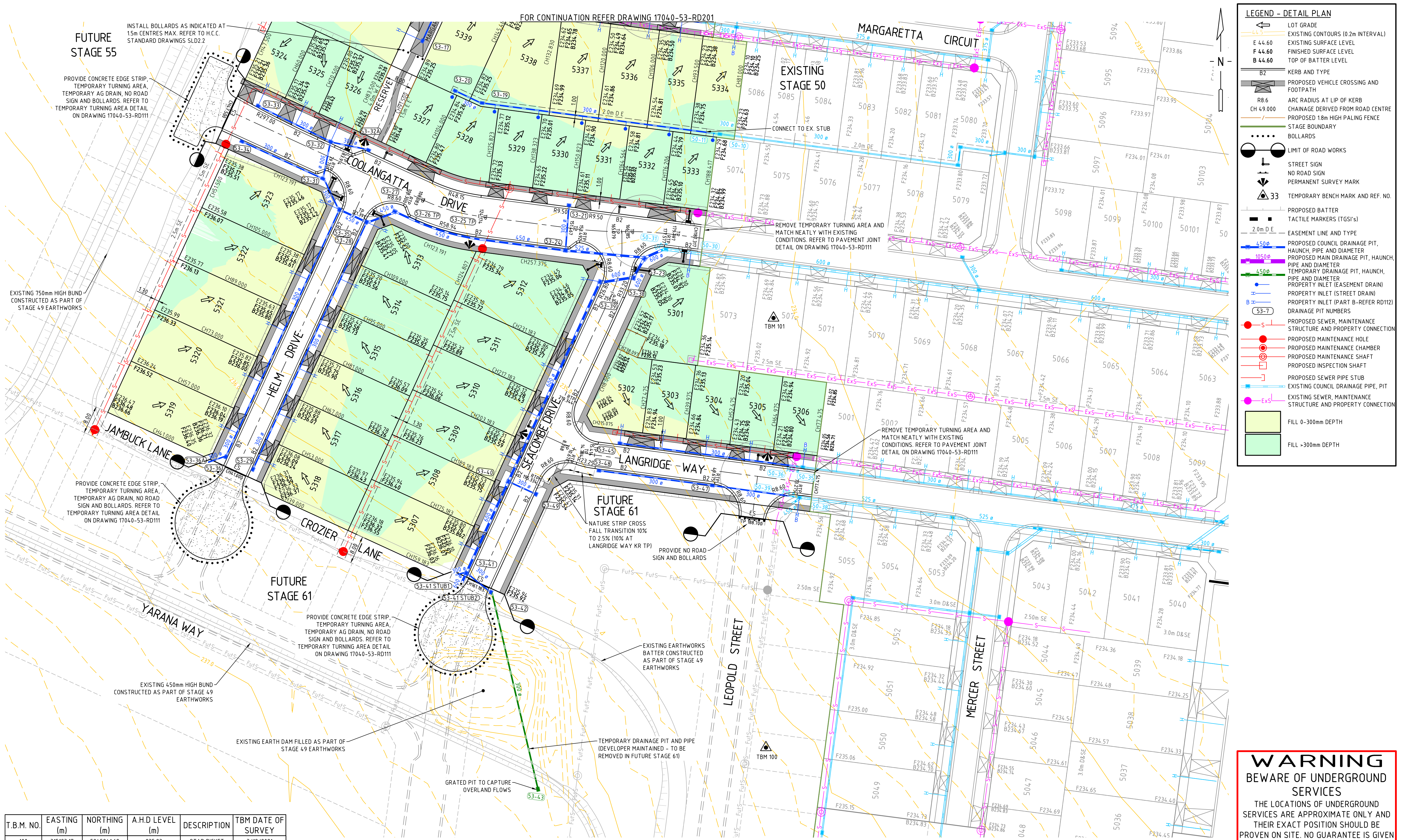

WARNING
BEWARE OF UNDERGROUND SERVICES
THE LOCATIONS OF UNDERGROUND SERVICES ARE APPROXIMATE ONLY AND THEIR EXACT POSITION SHOULD BE PROVEN ON SITE. NO GUARANTEE IS GIVEN THAT ALL EXISTING SERVICES ARE SHOWN. A DBYD ENQUIRY ON 1100 MUST BE MADE BY THE CONTRACTOR PRIOR TO COMMENCEMENT OF WORKS.

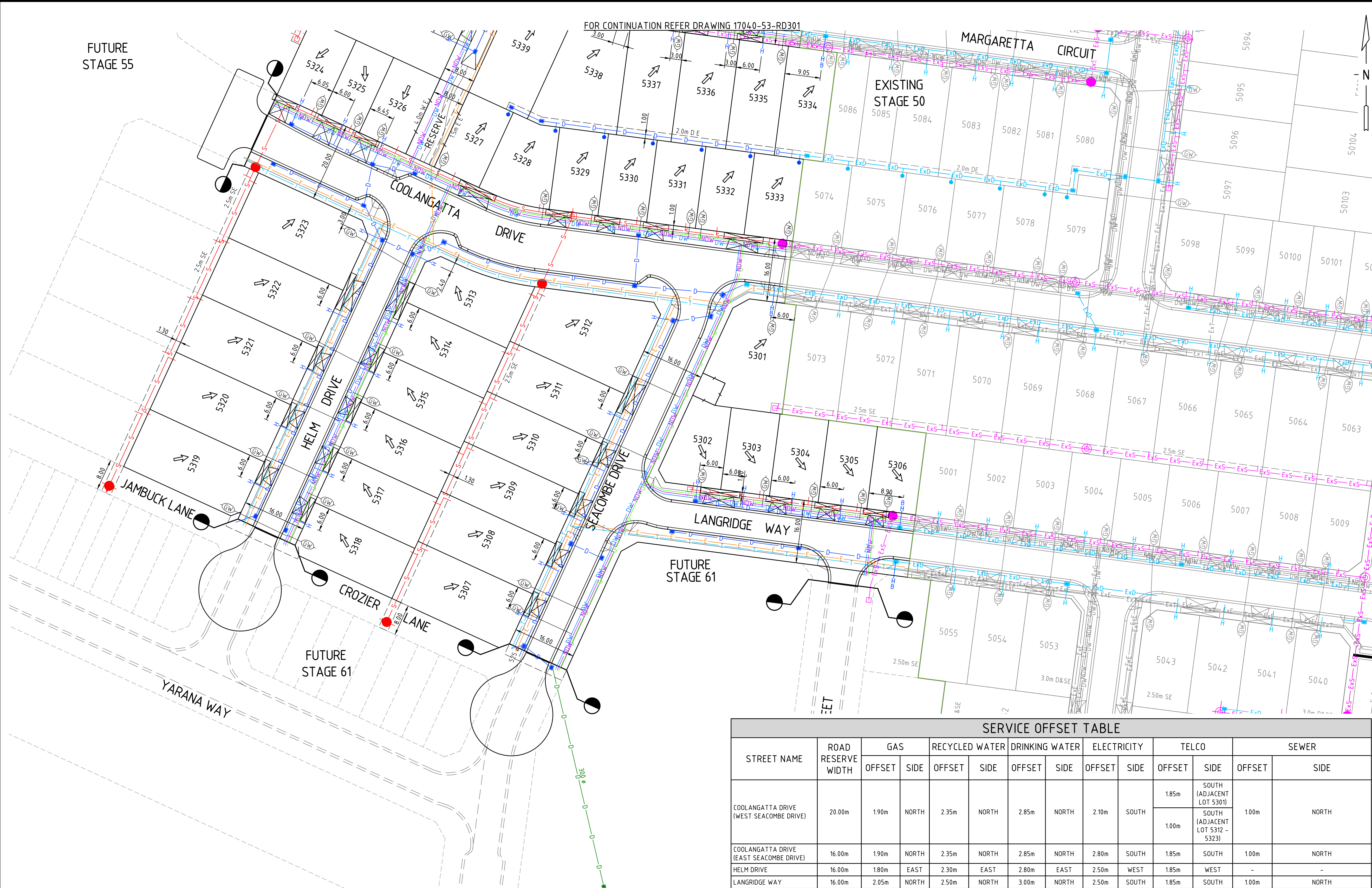

LEGEND - SERVICES PLAN

- LOT GRADE
- KERB
- PROPOSED VEHICLE CROSSING AND FOOTPATH
- PROPOSED STAGE BOUNDARY
- PROPOSED RETAINING WALL
- BOLLARDS
- LIMIT OF ROAD WORKS
- EASEMENT LINE AND TYPE
- PROPOSED GAS
- PROPOSED NON-DRINKING WATER
- PROPOSED DRINKING WATER
- PROPOSED ELECTRICITY
- PROPOSED TELCO
- PROPOSED GAS AND WATER CONDUIT
- PROPOSED GAS CONDUIT
- PROPOSED WATER CONDUIT
- PROPOSED COUNCIL DRAINAGE PIT AND DRAINAGE PIPE
- PROPOSED MAIN DRAINAGE PIT AND PIPE
- TEMPORARY COUNCIL DRAINAGE PIT AND DRAINAGE PIPE
- PROPERTY INLET (EASEMENT DRAIN)
- PROPERTY INLET (STREET DRAIN)
- TABLE DRAIN
- PROPOSED SEWER, MAINTENANCE STRUCTURE AND PROPERTY CONNECTION
- PROPOSED MAINTENANCE HOLE
- PROPOSED MAINTENANCE CHAMBER
- PROPOSED MAINTENANCE SHAFT
- PROPOSED INSPECTION SHAFT
- PROPOSED GAS CHECK
- PROPOSED SEWER PIPE STUB
- EXISTING GAS
- EXISTING NON-DRINKING WATER
- EXISTING DRINKING WATER
- EXISTING ELECTRICITY
- EXISTING TELCO
- EXISTING OVERHEAD ELECTRICITY
- EXISTING OPTIC FIBRE
- EXISTING GAS AND WATER CONDUIT
- EXISTING COUNCIL DRAINAGE PIPE, PIT
- EXISTING MAIN DRAINAGE PIPE, PIT
- EXISTING DRAINAGE PROPERTY INLET CONNECTION
- EXISTING DRAINAGE HOUSE DRAIN CONNECTION
- EXISTING SEWER, MAINTENANCE STRUCTURE AND PROPERTY CONNECTION

SERVICE OFFSET TABLE													
STREET NAME	ROAD RESERVE WIDTH	GAS		RECYCLED WATER		DRINKING WATER		ELECTRICITY		TELCO		SEWER	
		OFFSET	SIDE	OFFSET	SIDE	OFFSET	SIDE	OFFSET	SIDE	OFFSET	SIDE	OFFSET	SIDE
COOLANGATTA DRIVE (WEST SEACOMBE DRIVE)	20.00m	190m	NORTH	2.35m	NORTH	2.85m	NORTH	2.10m	SOUTH	1.85m	SOUTH (ADJACENT LOT 5301)	1.00m	NORTH
										1.00m	SOUTH (ADJACENT LOT 5312 – 5323)		
COOLANGATTA DRIVE (EAST SEACOMBE DRIVE)	16.00m	190m	NORTH	2.35m	NORTH	2.85m	NORTH	2.80m	SOUTH	1.85m	SOUTH	1.00m	NORTH
HELM DRIVE	16.00m	180m	EAST	2.30m	EAST	2.80m	EAST	2.50m	WEST	1.85m	WEST	-	-
LANGRIDGE WAY	16.00m	2.05m	NORTH	2.50m	NORTH	3.00m	NORTH	2.50m	SOUTH	1.85m	SOUTH	1.00m	NORTH
MARGARETTA CIRCUIT	16.00m	190m	SOUTH/ WEST/ NORTH	2.35m	SOUTH/ WEST/ NORTH	2.85m	SOUTH/ WEST/ NORTH	2.50m	NORTH/ EAST/ SOUTH	1.85m	NORTH/ EAST/ SOUTH	1.00m	NORTH (LOTS 5361-5357) (LOTS 5352-5349) 5353-5356)
MARGARETTA CIRCUIT CONCRETE DRIVEWAY	8.00m	150m	WEST	2.00m	WEST	2.50m	WEST	0.60m	EAST	0.50m	WEST	-	-
SEACOMBE DRIVE	16.00m	1.70m	EAST	2.15m	EAST	2.65m	EAST	2.30m	WEST	1.00m	WEST	-	-
NOTE: OFFSETS FOR ELECTRICITY AND TELCO ARE INDICATIVE ONLY. REFER TO APPROVED ELECTRICAL AND TELCO PLANS FOR FINAL INSTALLATION OFFSETS.													

WARNING

BEWARE OF UNDERGROUND SERVICES

THE LOCATIONS OF UNDERGROUND SERVICES ARE APPROXIMATE ONLY AND THEIR EXACT POSITION SHOULD BE PROVEN ON SITE. NO GUARANTEE IS GIVEN THAT ALL EXISTING SERVICES ARE SHOWN. A DBYD ENQUIRY ON 1100 MUST BE MADE BY THE CONTRACTOR PRIOR TO COMMENCEMENT OF WORKS.

CAD FILE: F:\SYNERGY\TEMP\120SYNERGY\SERVERSERVICE\120A\014\478-CB03-4067-8884-5E51301F6881\17040-53-RD301-170302.DWG
PLOT DATE: Fri Oct 20 11:15:57 2023

REV	DESCRIPTION	APPROVED	DATE
4	AS CONSTRUCTED	J.J.	20.10.23
3	TELCO OFFSET UPDATED	J.J.	09.08.23
2	DRAINAGE STUB TO FUTURE LANEWAY ADDED	G.R.	16.12.22
1	SERVICE OFFSETS UPDATED	G.R.	08.12.22
0	CONSTRUCTION ISSUE	G.R.	29.11.22

DRAWN: M.HURA	DESIGNED: A.ARABO	VERIFIED: P.MASEMANN	APPROVED: J.JOYCE
---------------	-------------------	----------------------	-------------------

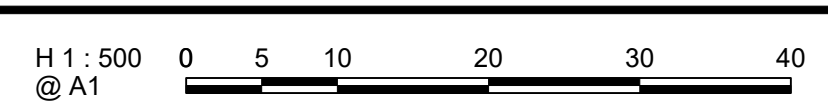

CLIENT:

merrifield

MAB **GPC**

verve

Ground Floor, 207-213 Waverley Road,
Malvern East VIC 3145
TEL : 03 8573 1500 verveprojects.com
© Verve Projects Pty Ltd.

COUNCIL: HUME CITY COUNCIL

PROJECT: MERRIFIELD LIVING - SECTION E STAGE 53 MICKLEHAM

ISSUE: **AS CONSTRUCTED**

TITLE: SERVICES PLAN SHEET 2

MELWAY REF: 366 F1

PROJECT No: 17040-53

DWG No: RD302

REVISION: 4